

MOPIC Mirror

USER GUIDE

Ver 1.2.x

MOPIC

www.mopiclabs.com

INDEX

- [What is 'MOPIC Mirror'?](#)
- [Prior to Use – Connections](#)
- [Prior to Use – Graphics Optimization & Application Optimization](#)
- [How to use - When Light Field 3D Display is the 2nd display](#)
- [How to use - When Light Field 3D Display is used as a stand-alone display](#)
- [Appendix – How to Use 'VLC Media Player'](#)

MOPIC Mirror

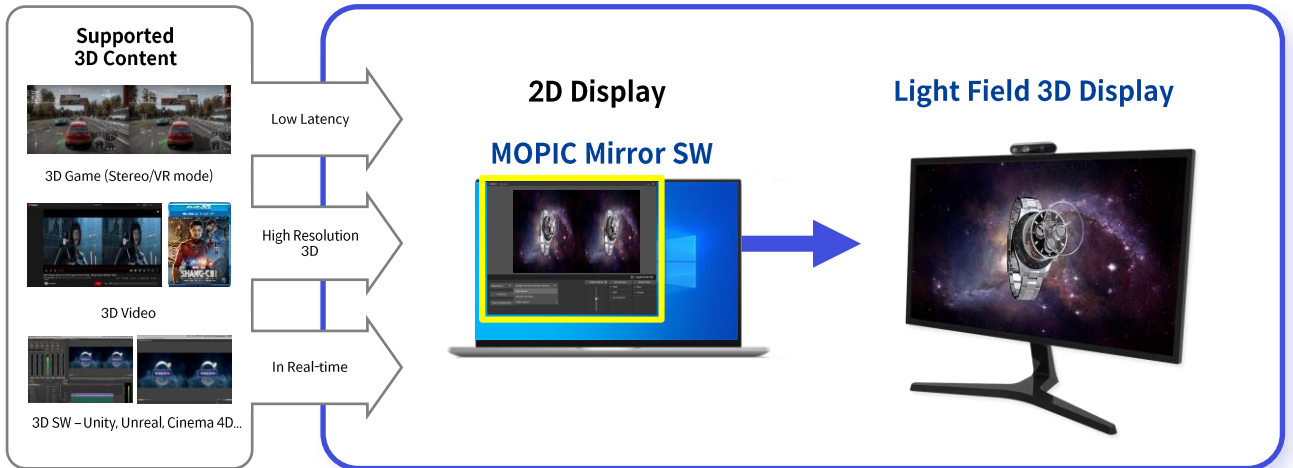

It is a software application that captures a selected area of the main display as is and mirrors it on MOPIC's Light Field 3D Display. To display stereoscopic images with no wearables, it tracks user's viewing position and delivers optimal stereoscopic images to user in real time.

Recommended PC Configurations

CPU	Intel i7, 10th gen or better
GPU	Nvidia GeForce RTX 2080 Ti or GeForce RTX 30xx
OS Version	Windows10 1903(May 2019 update) or later
RAM	16GB dual channel or better
GPU Memory	6GB or better
I/O	1 x DisplayPort 1.2 or 1 x HDMI 2.0, USB3.0

! Note

MOPIC Mirror uses the camera at the top of the Light Field 3D Display to track user's viewing position in the angle of view in real time and optimize the array of stereoscopic images so that said images are delivered to user's viewing position.

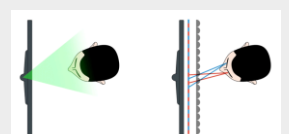

Prior to Use

– Connections

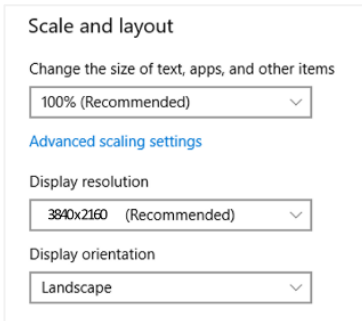

- A. Connect the **PC to the Light Field 3D Display**.
- B. Under Desktop-Display Settings, **Extend displays, Set the Display Scale of the Light Field 3D Display to 100%, and Set the Display resolution to 4K**.
- C. Install MOPIC Mirror SW on the PC you wish to connect to.

*** Caution: use the enclosed authentic cables**

– Graphics Optimization for Laptop user

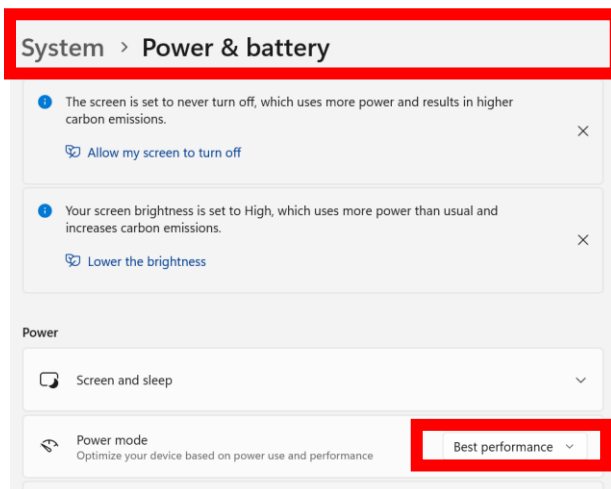

- A. Must use power mode (cable), do not use battery.
- B. Set Power Mode to Best performance.

- Application Optimization for all

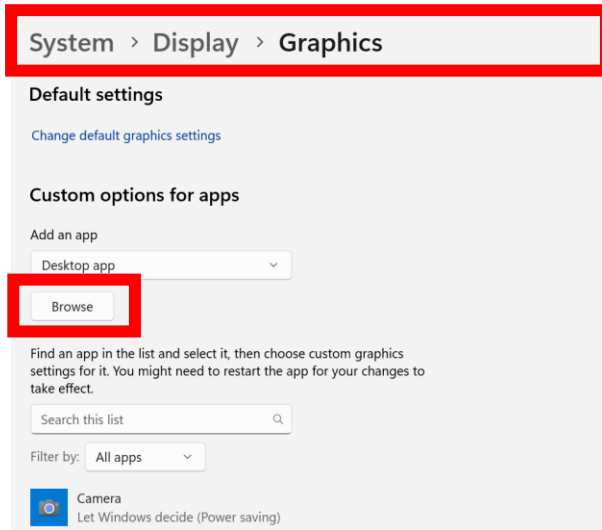

- A. Under [Desktop - System - Display - Graphics], open the setting window.
- B. Then, Click the [Browse] button.

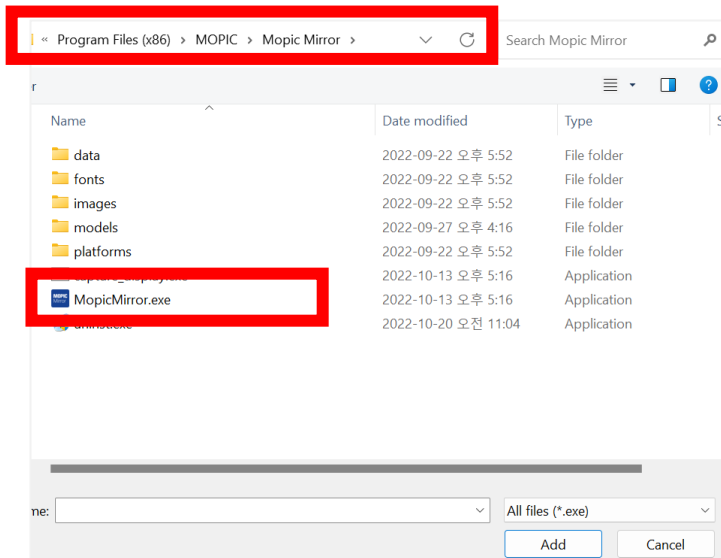

- C. Find the path where the MOPIC Mirror is installed and select the executable file.

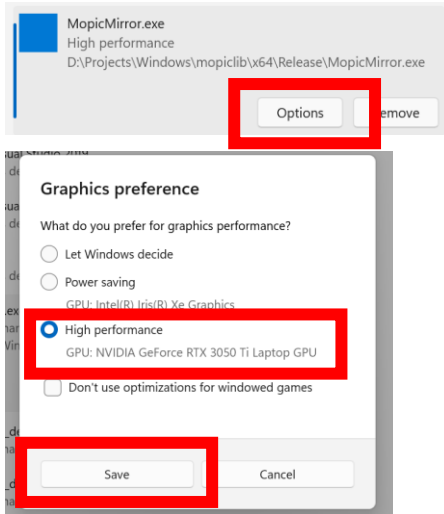

- D. Scroll down to find the application you added.
- E. Click Options button and select the [High performance] option.
- F. And click the [Save] button.

Processes					
Name	Stat...	CPU	Memory	Disk	Network
MOPIC Mirror Application		0.9%	114.0 MB	0 MB/s	0 Mbps
		25%	40%	2%	0%
					GPU 1 - Copy

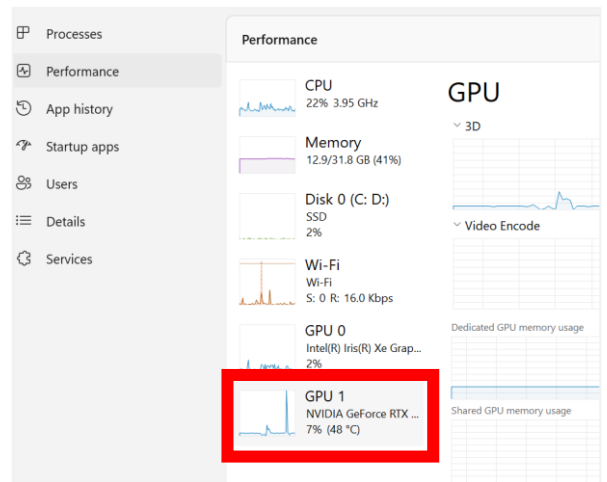

- G. Restart the Mopic Mirror and Check performance.

How to use MOPIC Mirror - When Light Field 3D Display is the 2nd display

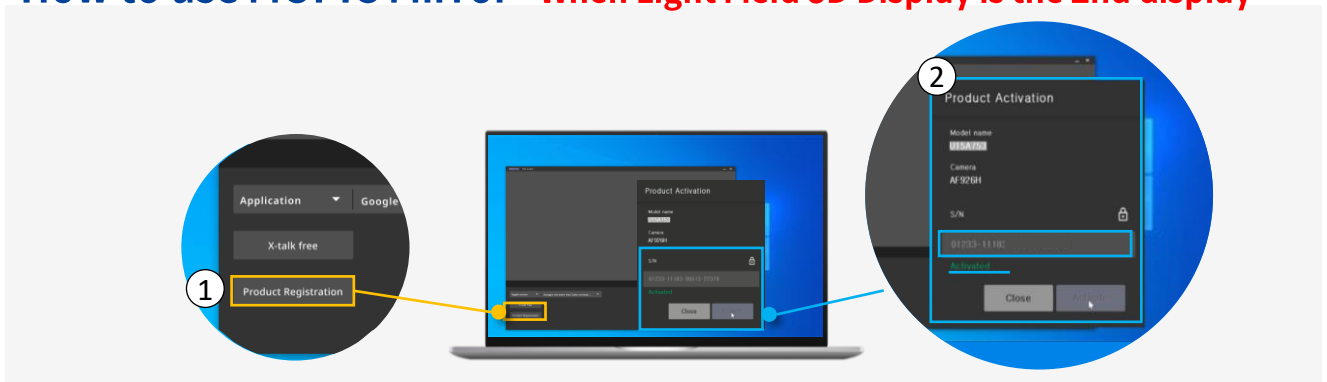

- A. Product activation is automatic, but you must connect to the Internet in the beginning. No Internet connection is needed afterward.
- B. If the product is successfully activated, you can see the 'activated' sign through the ① [Product Registration] ② pop-up of [Product Activation].

*** When you change your PC, it must have an Internet connection for the first time.**

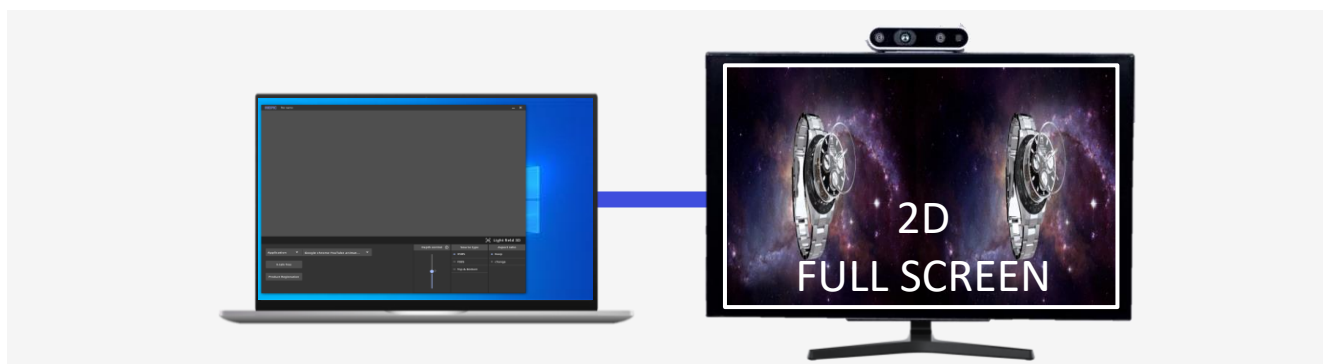

- C. **Play stereoscopic 3D content on the Light Field 3D Display in full-screen mode.**

Stereoscopic 3D content are 3D content that have images for left and right eyes separated in Side By Side (SBS) or in Top And Bottom (TAB) 3D format.

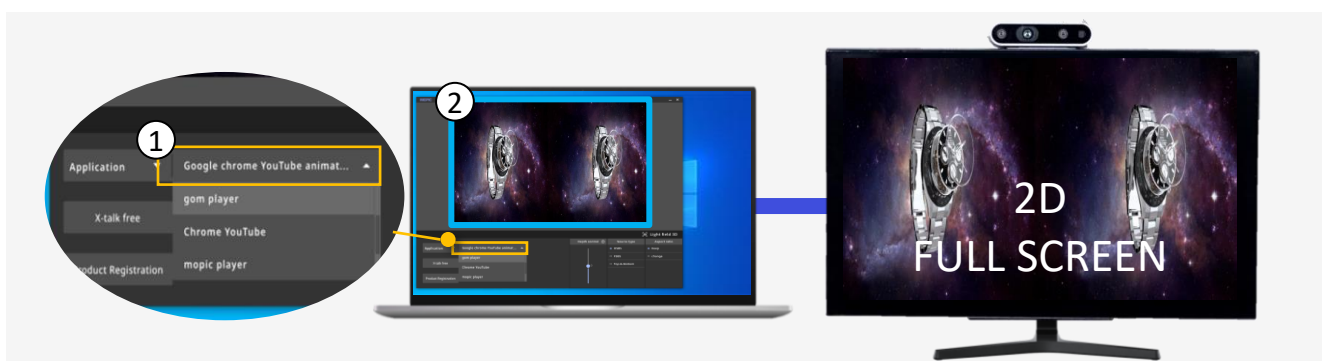

- D. Click ① Select the capture target button and click the content running in full-screen mode on the Light Field 3D display and the content will be displayed in the ② [Preview] area.

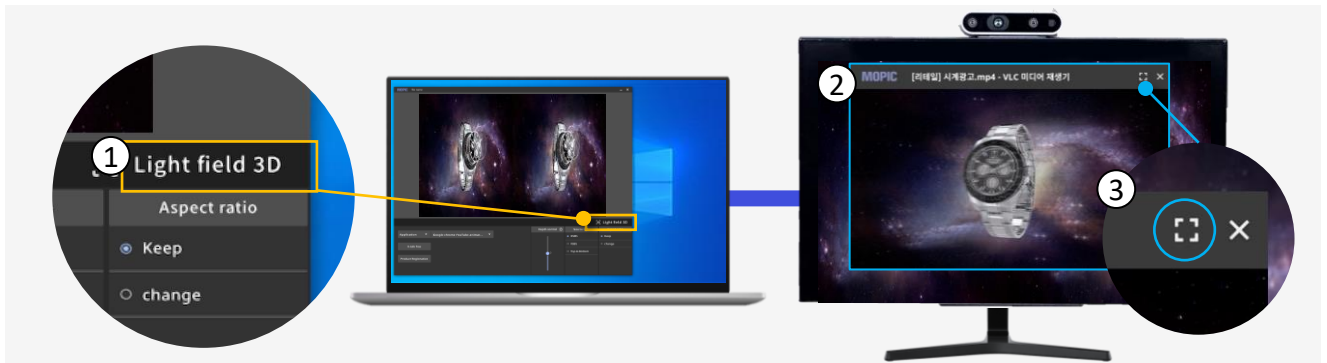

- E. Click the ① [Light Field 3D] button for a ② [View] pop-up, and click the ③ button to run it in full-screen mode.

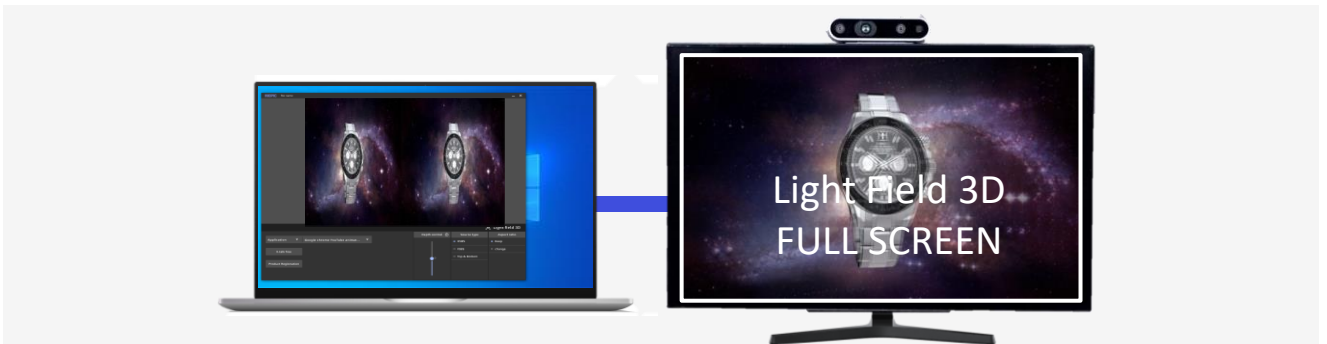

- Stereoscopic images can be viewed in 'full screen mode' only on the Light Field 3D Display.
- Use it with a player that continues playing in the background (Not supported by Window Media Player)

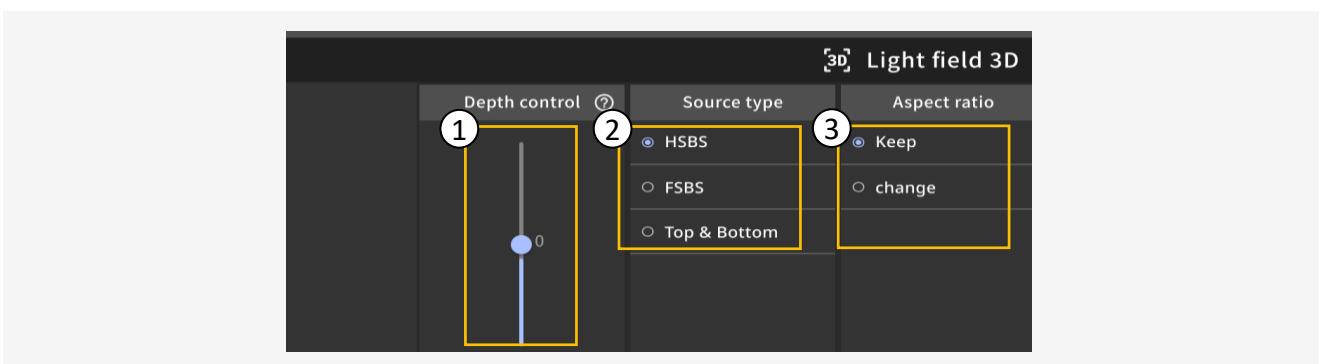

- F. Three-dimensional effects can be adjusted with the ① [Depth control] SeekBar. If you raise the bar from the default value of 0, the image appears to pop out from the screen, and when the bar is lowered, it appears to go deep into the screen.
- G. Click the ② button in the [Source type] area to select relevant stereoscopic 3D content format.
- H. Click the ③ button in the [Aspect ratio] area to keep the stereoscopic image the same as the original content's aspect ratio (Keep) or to view it in full screen (Change) regardless of the original content's aspect ratio.

How to use MOPIC Mirror - When Light Field 3D Display is used as a stand-alone display

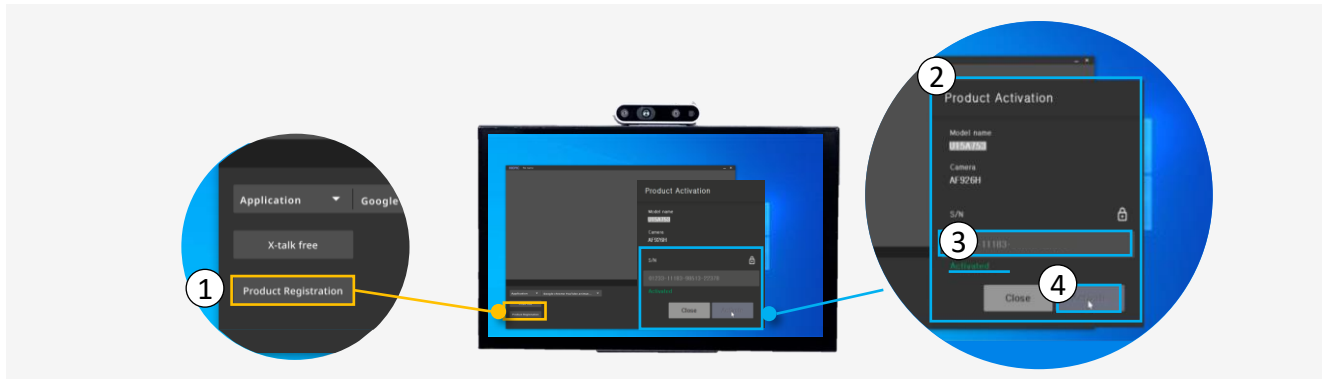

- A. Product activation is automatic, but you must connect to the Internet in the beginning. No Internet connection is needed afterward.
- B. If the product is successfully activated, you can see the 'activated' sign through the ① [Product Registration] ② pop-up of [Product Activation].

*** When you change your PC, it must have an Internet connection for the first time.**



C. Select 3D content you want to watch and go full screen while MOPIC Mirror is running .

- C. Stereoscopic 3D content are 3D content that have images for left and right eyes separated in Side By Side (SBS) or in Top And Bottom (TAB) 3D format.

D. Press ① ALT and Tab keys, and click on the ② MOPIC Mirror window



- E. Click ① Select the capture target button and click the content running in full-screen mode on the Light Field 3D display and the content will be displayed in the ② [Preview] area.

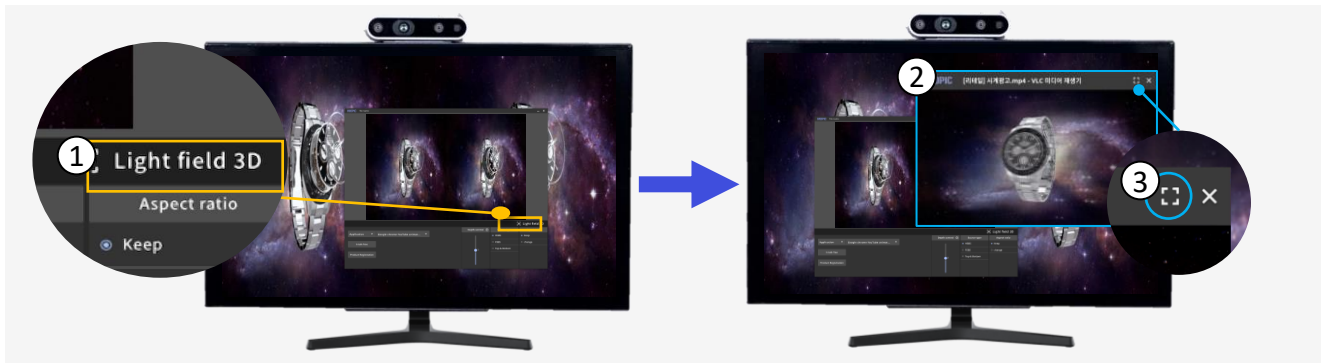

- F. Click the ① [Light Field 3D] button for a ② [View] pop-up, and click the ③ button to run it in full-screen mode.



- **Stereoscopic images can be viewed in 'full screen mode' only on the Light Field 3D Display.**
- **Use it with a player that continues playing in the background (Not supported by Window Media Player)**
 - **Highly Recommend Media Player: VLC Player ([FREE DOWNLOAD](#))**

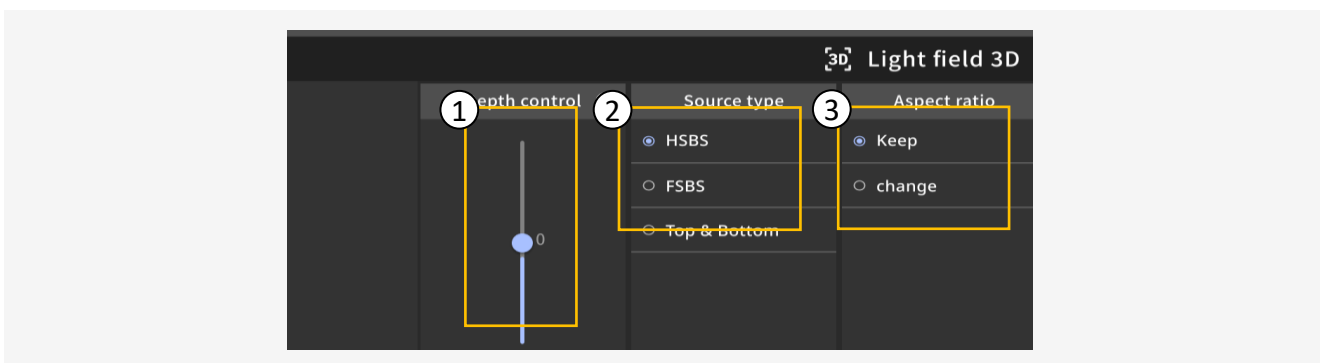

- G. Three-dimensional effects can be adjusted with the ① [Depth control] SeekBar. If you raise the bar from the default value of 0, the image appears to pop out from the screen, and when the bar is lowered, it appears to go deep into the screen.
- H. Click the ② button in the [Source type] area to select relevant stereoscopic 3D content format.
- I. Click the ③ button in the [Aspect ratio] area to keep the stereoscopic image the same as the original content's aspect ratio (Keep) or to view it in full screen (Change) regardless of the original content's aspect ratio.

Appendix

– How to Use ‘VLC Media Player’

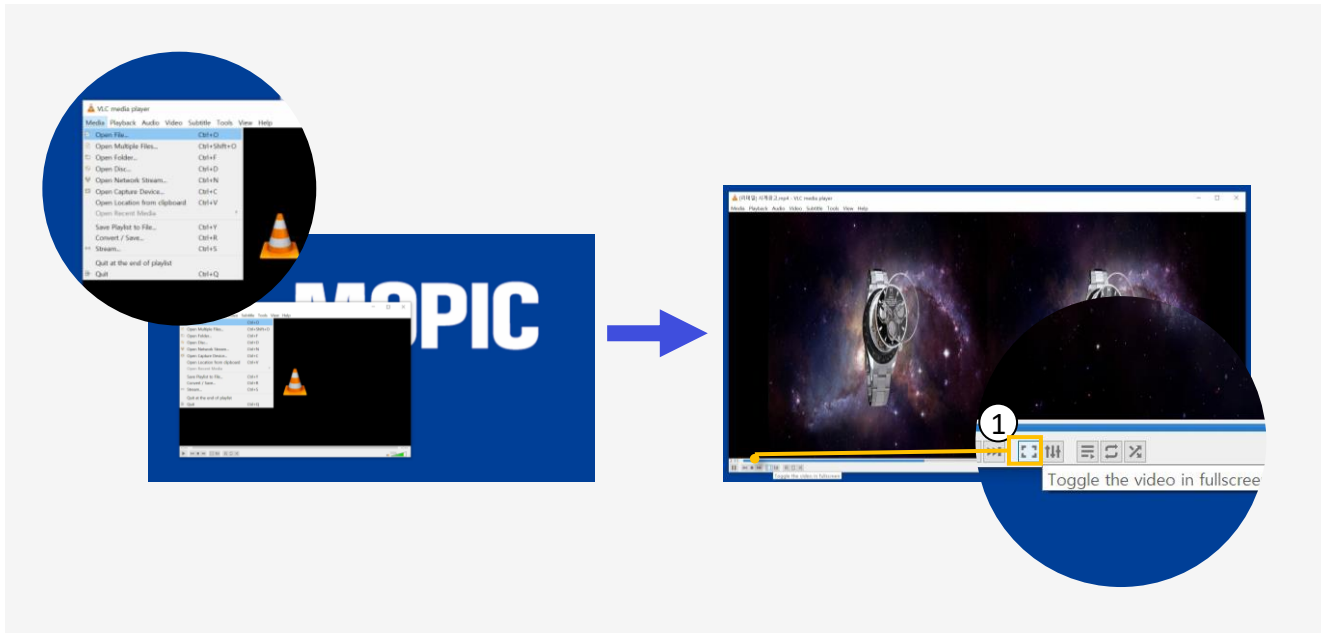

A. Install VLC Media Player SW on the PC you wish to connect to.

(Download Link: <https://vlc-media-player.en.softonic.com/>)

B. Under Media-Open File, Play the 3D Video.

C. Click the ① [Toggle] button to play video in full screen.

* Stereoscopic images can be viewed in ‘full screen mode’ only on the Light Field 3D Display.